

HONDA AFRICA TWIN CRF1100L ADVENTURE '20- / CRF1100L '20-

M O U N T I N G I N S T R U C T I O N S

REF 3887

BEAK

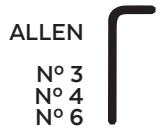

ID	PIEZA/PART	DESCRIPCIÓN	DESCRIPTION	QTY	REF
1		Pico	Beak	1	3887JM3
2		Soporte chasis para HONDA AFRICA TWIN '20-	Chassis Support for HONDA AFRICA TWIN '20-	1	SOPOR3P6CN-3887
		Soporte chasis para HONDA AFRICA TWIN ADVENTURE '20-	Chassis Support for HONDA AFRICA TWIN ADVENTURE '20-	1	SOPOR3P6CA-3887
3		Soporte base	Base Support	1	SOPOR3P6B--3887
4		Tornillo Allen M5x11 Ø11 ISO 7380	M5x11 Ø11 ISO 7380 Allen screw	4	TORNI-AI----520
5		Tornillo Allen M6x16 Ø11 ISO 7380	M6x16 Ø11 ISO 7380 Allen screw	2	TORNI-I7380-403
6		Arandela de nylon M5x1	M5x1 nylon washer	4	ARNV00000000245
7		Arandela de goma Ø4,5 x Ø11 x 2mm	Ø4,5 x Ø11 x 2mm rubber washer	4	ARAND-EPDM--722
8		Tapón tornillo M5 ISO 7380	M5 ISO 7380 Screw Cap	4	TAPON-----85
9		Tornillo Allen M8x35 DIN 912	M8x35 DIN 912 Allen Screw	2	TORNI-AD912-196
10		Tuerca autoblocante M8	M8 Lock nut	2	TUEA-D985.8-M8-
11		Kit adhesivos	Sticker kit	1	ADHESI-VI--3887

HONDA AFRICA TWIN CRF1100L ADVENTURE '20- / CRF1100L '20-

INSTRUCCIONES DE MONTAJE - MOUNTING INSTRUCTIONS - MONTAGEANLEITUNG

1

DISASSEMBLY
DESMONTAJE

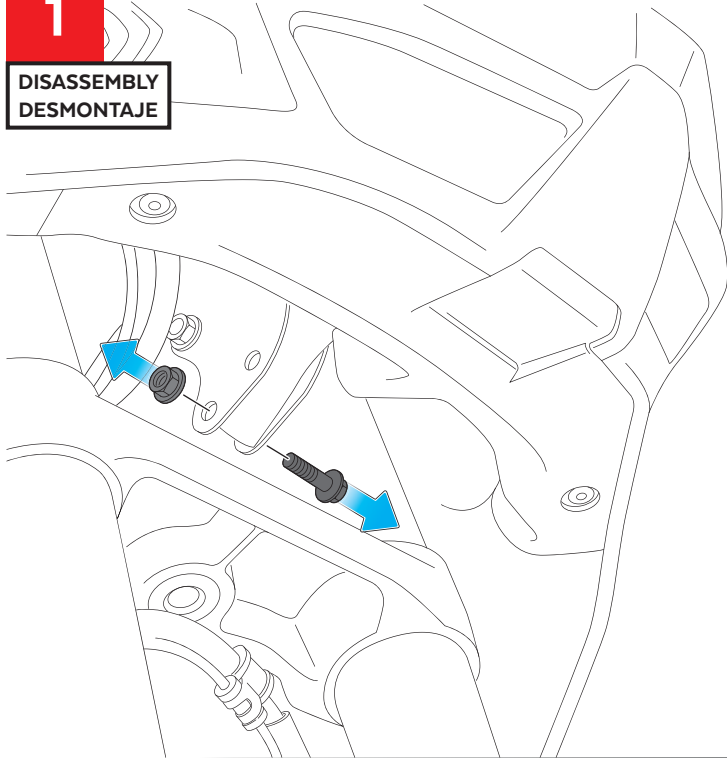

2

ASSEMBLY
MONTAJE

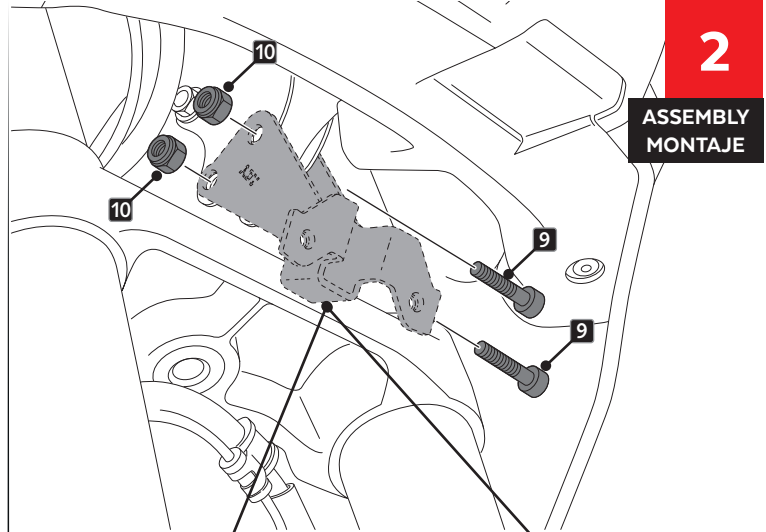

HONDA AFRICA TWIN '20-

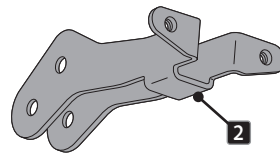

HONDA AFRICA TWIN ADVENTURE '20-

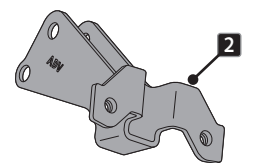

3

ASSEMBLY
MONTAJE

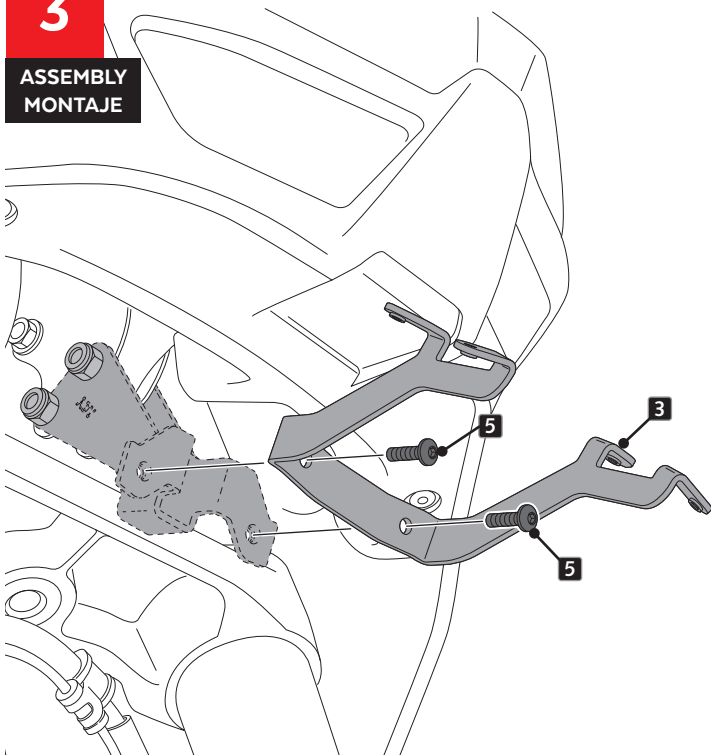

4

ASSEMBLY
MONTAJE

