

YAMAHA TRACER 900 '18- / 900GT '18-

REF 3762

CÚPULA TOURING PARA / TOURING SCREEN FOR / TOURENSCHEIBE FÜR





PHILLIPS



ALLEN

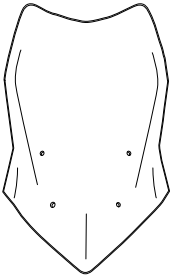

Nº 3

ID.	PIEZA / PART	DESCRIPCIÓN	DESCRIPTION	QTY.	REF.:
1		Cúpula touring	Touring Screen	1	3762F/H/WM3
2		Silentblock Ø9xØ6x8mm	Ø9xØ6x8mm silentblock	4	AROPASACABLES-3
3		Casquillo con valona Ø12xØ6,8x7,3	Ø12xØ6,8x7,3 bush with flange	4	CASQUI-1A---750
4		Tornillo M5x25 Ø11 ISO7380	M5x25 Ø11 ISO7380 allen screw	4	TORNI-I7380-766
5		Tapón M5 ISO7380	M5 ISO7380 screw cap	4	TAPON-----85

YAMAHA TRACER 900 '18- / 900GT '18-

INSTRUCCIONES DE MONTAJE - MOUNTING INSTRUCTIONS - MONTAGEANLEITUNG

1

**DISASSEMBLY
DESMONTAJE**

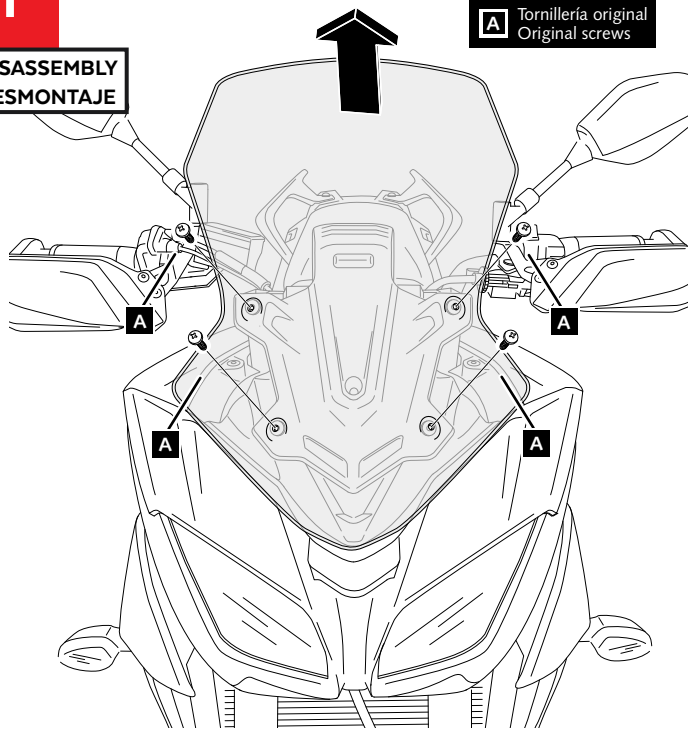

2

**ASSEMBLY
MONTAJE**

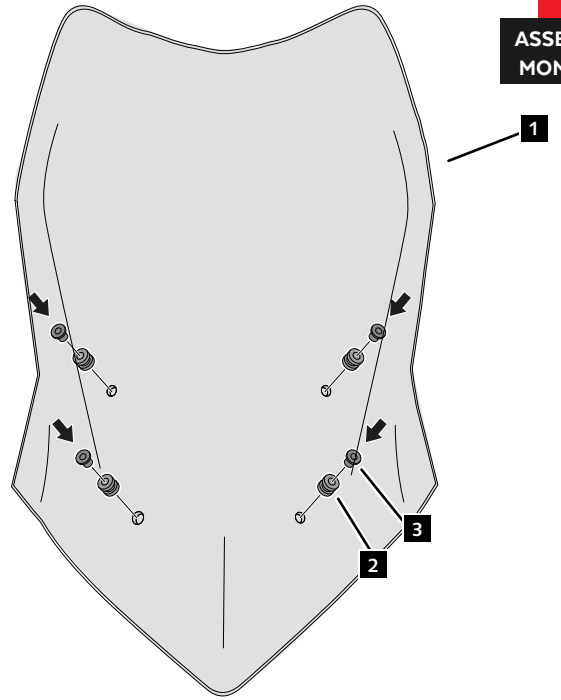

3

**ASSEMBLY
MONTAJE**

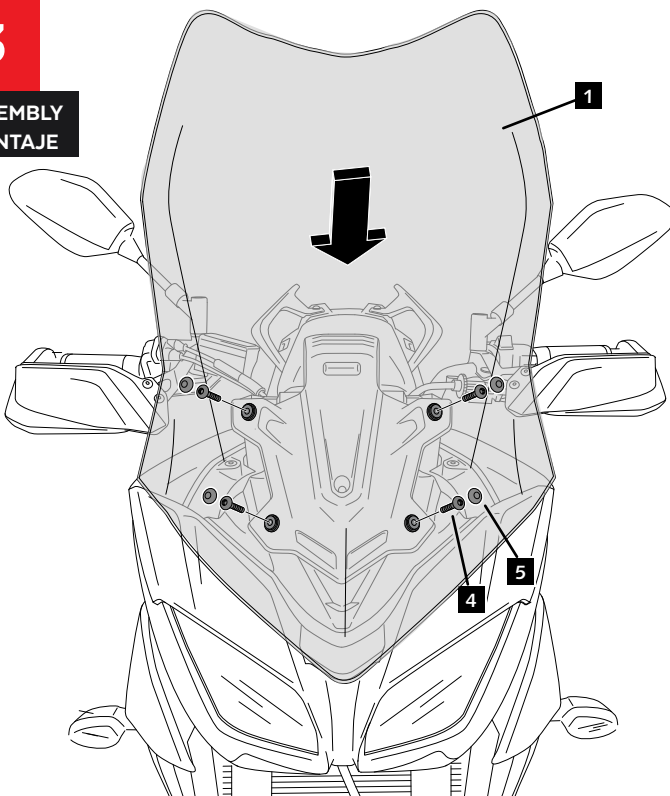

4

**ASSEMBLY
MONTAJE**

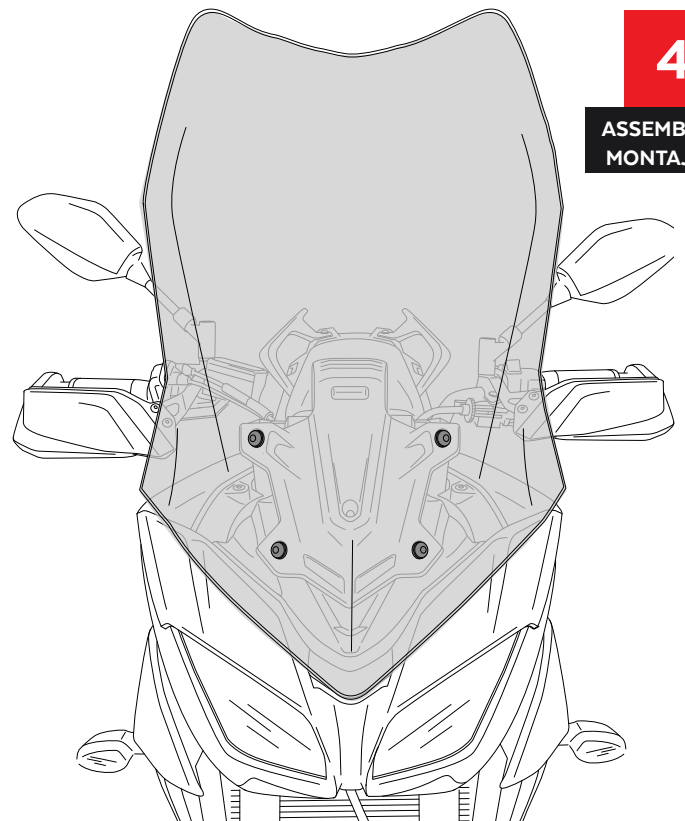

VISERA MULTIREGULABLE MULTI-ADJUSTABLE VISOR

INSTRUCCIONES DE MONTAJE - MOUNTING INSTRUCTIONS - MONTAGEANLEITUNG

TIPO/TYPER C - TIPO/TYPER C - TIPO/TYPER C

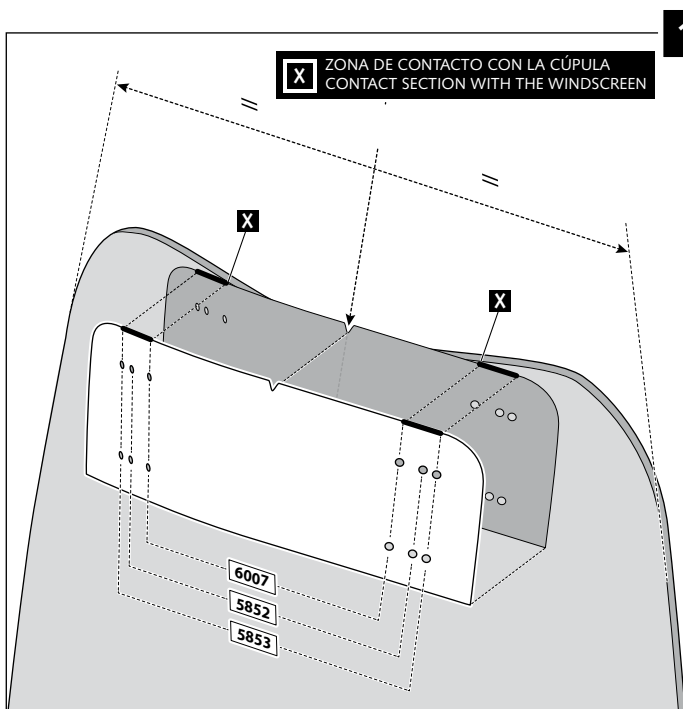

1

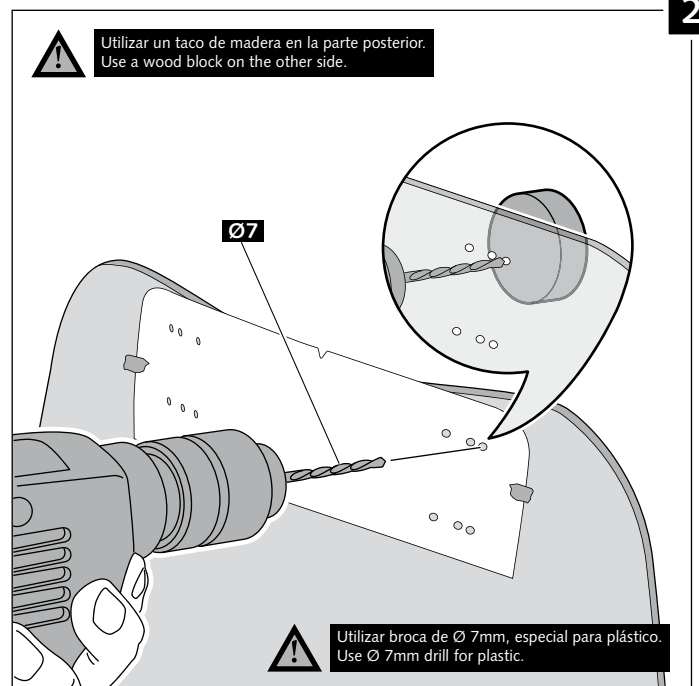

2

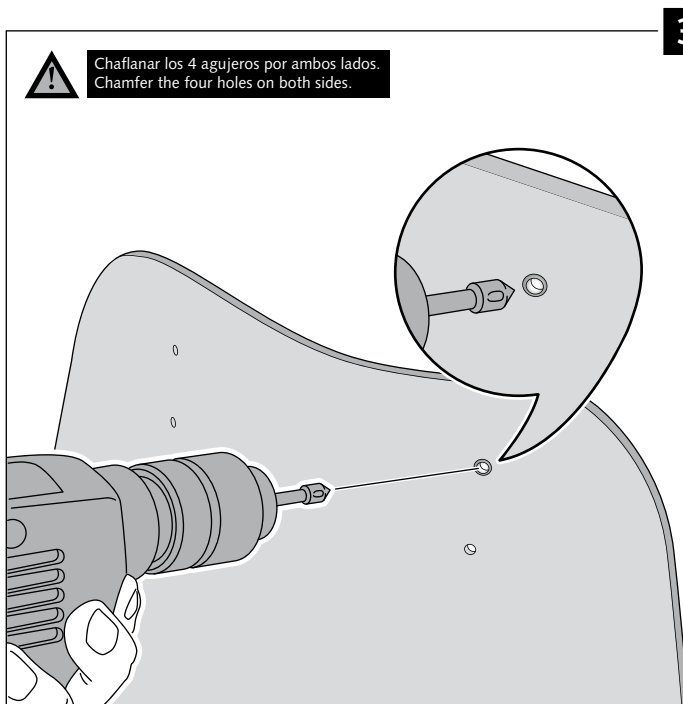

3

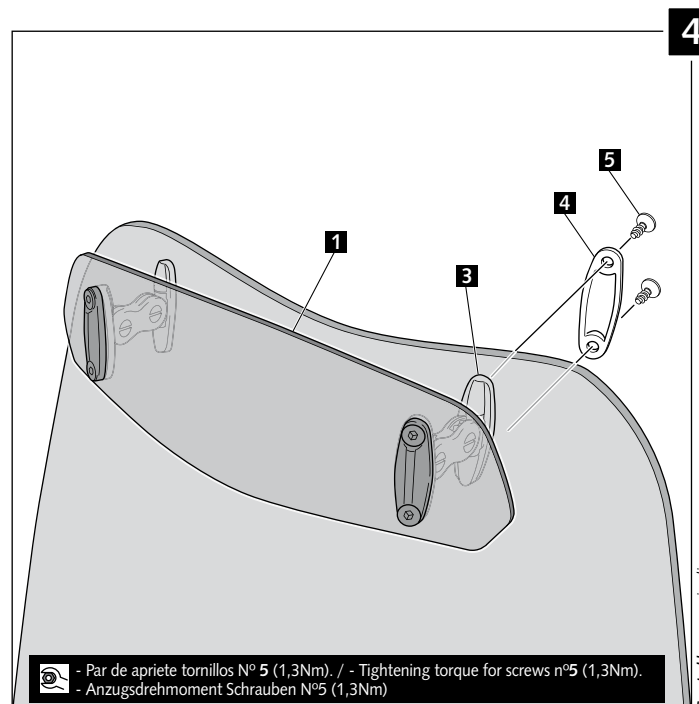

4